

# VacuStar WR 2500 – 3100 – 4000

## Liquid ring compressor vacuum-pump

CVS develops and manufactures compressor vacuum pumps specifically designed for installation in vacuum trucks. The development is made in close collaboration with our customers. This guarantees the optimum product for your application.

**The liquid ring compressor vacuum-pump:** The series WR was developed especially for the high requirements on mounting in suction vehicles, municipal vacuum trucks and combination trucks (combined suction and water jetting).

### Features

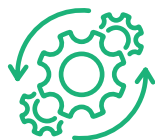

#### High quality

compressor vacuum-pumps from CVS for higher suction level and more suction power



#### Unique and robust design

guarantee long lasting performance and high operating hours



#### Compact and light-weight

compressor vacuum-pumps for higher payload on the truck

#### Compressor vacuum-pumps with system:

The series WR consists of 5 sizes with a volume flow of up to 4,063 m<sup>3</sup>/h / 2391 cfm.



## Advantages

- Swivel mounted pump between the mounting feet
- Suction and pressure flange can be connected electively on shaft side or opposite
- Mechanical seal
- Low weight design by using aluminum
- Connection flanges can be swiveled
- Installation friendly design
- Only one water drain

## Optional

- Ceramic-coated housing and end covers for extreme conditions. Excellent resistance to abrasion, erosion and cavitation.
- Chemical resistance to acid and alkaline media.
- Stainless steel impeller made of V2A, corrosion and abrasion resistant, well suited for low temperature applications, resistant to weak organic and inorganic acids.
- The integrated cell ventilation protects the water ring pump against cavitation > Increased service life.
- Drive via v-belt or hydraulic



### Technical data

	Unit	VacuStar WR 2500	VacuStar WR 3100	VacuStar WR 4000
Max. suction volume flow	m <sup>3</sup> /h (cfm)	2,500 (1470)	3,100 (1825)	4063 (2391)
Max. operating pressure	bar g (psig)	1.5 (21.3)		1.0 (14.5)
Max. operating vacuum (Depending on cooling water temperature)	mbar (HG <sup>o</sup> )	130 / 26		
Nominal speed range	1/min (rpm)	800 – (1,600)		800 – (1,300)
Max. power requirement at 0.5 bar g / 7.25 psig	kW (hp)	77.0 (105)	94.0 (128)	131.5 (176)
Sound pressure level in 7 m distance at 400 mbar /18 HG <sup>o</sup>	dB(A)	70	72	73
Weight	kg (lb)	175 (385)	192 (422)	298 (657)

a = VacuStar WR 2500 | b = VacuStar WR 3100

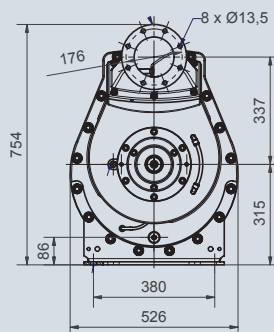
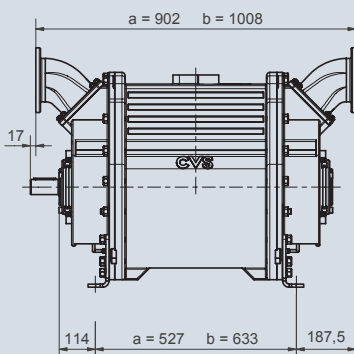

VacuStar WR 4000

